



Respiratory Syncytial Virus Rapid Test

-Nasal Secretions

The Respiratory Syncytial Virus(RSV) Rapid Test is an in vitro immunoassay for the direct and qualitative detection of respiratory syncytial virus (RSV) antigens from human nasal/nasopharyngeal swabs or nasal washes/aspirates. It is intended to aid in the rapid diagnosis of RSV infection.

- Easy to use
- Less operations
- Accurate results in **15 min.**
- Cost-efficient



About RSV Infections

People infected with RSV usually show symptoms within 4 to 6 days after getting infected. Symptoms of RSV infection usually include:

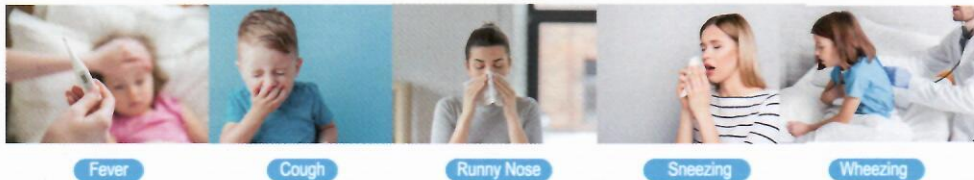

Test Procedure

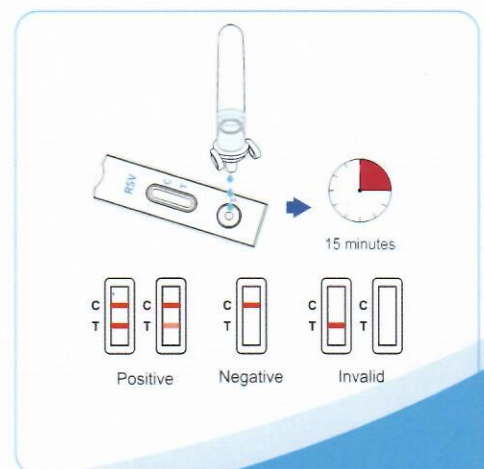
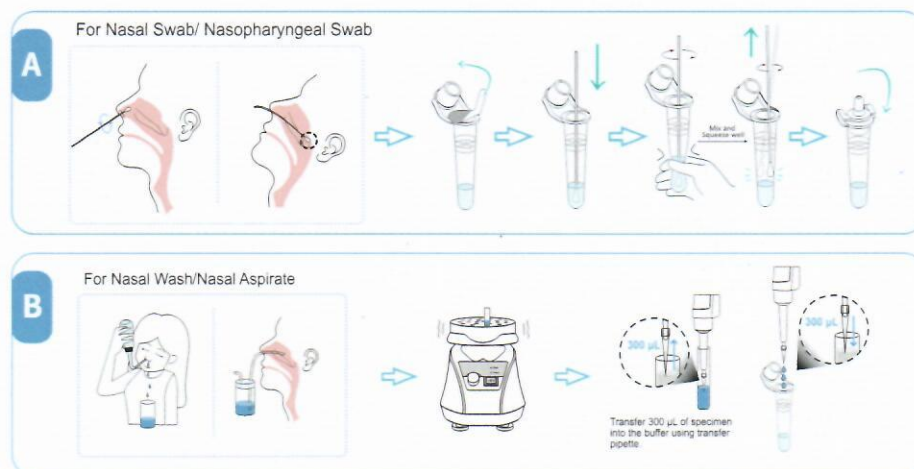

Assure Tech. (Hangzhou) Co.,Ltd.

Building 4, No. 1418-50, Moganshan Road
Gongshu District, Hangzhou,China 310011



400-853-5577
www.diareagent.com

